

# Pressure Gauge

Class 1,0

AT 4259

Dimension	PN	Temperature range	Material
G 3/8	Full scale value for temporary load	-40°C to +80°C	Stainless steel

## Range of Application

For measuring the pressure of liquefied or gaseous non-aggressive media, primarily water, air or steam. For pressure measurement of liquid or gaseous, aggressive media are both pressure gauges AT 4256 and AT 4259 in industrial design and is then called AT4256R and AT 4259R.

## UGC.31 Pressure Gauge

Pipe-mounted, with analogue display of instantaneous value. Pressure Gauge AT 4259 of Bourdon tube type. Class 1.0, housing diameter 100 mm, graded 0 -.... bar.



## Quality Assurance

PED, AFS 1999:4

## Material Specification

AT 4259	
2	Body chromium nickelsteel with bayonet unruffled capsule
3	Measuring element brass
4	Glass instrument glass

Parts in touch with media made by copper alloy

## Material Specification Industrial Design

AT 4256R, AT 4259R	
Body	Chromium nickelsteel with bayonet unruffled capsule
Measuring element	Stainless steel
Glass	Laminated protection glass
Wetted material	Stainless steel 1.4404

## Dimensions

AT 4259-15 /4259-10	
Standard Industrial design	
A	87
B	100
C	G 1/2 / G 3/8
D	50

Measurement in mm.

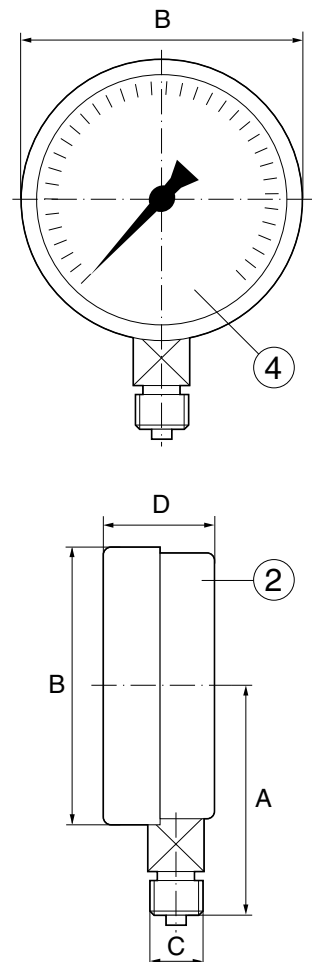

## Function and Design

The pressure gauge is a bourdon tube type, which involves a circle-formed tube spring with an oval cross-section. The system pressure internally affects the Bourdon tube so that it, at a certain pressure tends to straighten out. The free end of the Bourdon tube moves proportionally with the internal pressure. This movement is then converted by the measuring element into a movement/indication

value on the dial.

## Technical Information

	AT 4259	AT4259R
Media temperature	-40°C to +80°C	-40°C to +200°C
Ambient temperature	-40°C to +60°C	-40°C to +60°C
Accuracy class	1%	1%
Effect of temperature	0,4%/10°C	0,4%/10°C
IP klass	54	65
Max. working pressure	The hole scale value at resting load. 90% of the scale value at fluctuating loads.	The hole scale value at resting load. 90% of the scale value at fluctuating loads.

## Dimensioning

The scale range should be selected in accordance to the constant pressure that not should exceed 2/3 of the scale range.

## Accessories and Options

For complete pressure gauge sets including control pressure gauge valve, water trap pipe and pressure gauge valve, please see our AT 1800-1806 product sheet. The pressure gauges are also available in stainless steel, damping fluid-filled, with a connection tap on the back and with non-standard gradings.

## Installation

The pressure gauges are to be mounted so that they are both easy to read and protected against vibrations, heat, cold and high air humidity. For high fluid temperatures, a water trap pipe should be used. For pressure variations and vibrations, a damping fluid-filled pressure gauge should be used.

## Marking

The products are marked with Armatec (standard products), class and grading.

## How to order

### Exempel: AT 4259-10-6

AT 4259	-	10	6
Article no. AT 4256=bodydiam. 160 mm AT 4259=bodydiam. 100 mm	Execution - =standard D=damping fluid filled R=rust-resistant model U=decompression	DN -15	Grading

Rätten till ändringar utan föregående meddelande förbehålls.  
Armatec ansvarar inte för eventuella tryckfel eller misstänksfel.  
Dokumentet får kopieras endast i sin helhet.