

# Floating body gauge

AT 7730

<b>Dimension range</b> G 1/2	<b>PN</b> 20	<b>Temperature range</b> 5°C to +80°C	<b>Material</b> Stainless steel
---------------------------------	-----------------	--	------------------------------------

## Range of application

Immediate measurement of the flow of air or water.

## UGE.31 Flow gauge

Tube mounted with analog current flow indication.

## Quality assurance

According to PED 2016:1

## Material specification

1	Body	Stainless steel 1.4401
	Flow	
2	tube	Grilamid (PA-12)
3	Float	Stainless steel 1.4460 or 1.4460/PTFE depending on the measure area
	End	
4	piece	Nylon

## Dimension and weight

A	53
B	202
C	34
D	134
E	38
Weight	ca 950g

## Function and design

Float gauge in fluidised body-type for air or water. Measurement range in water 0.4 l / min to 30l / min and range in air 15NI / min to 700NI / min.

The instantaneous flow is read by the meter visually. The scale is adapted to the media. The flowmeter has an adjustment screw and is prepared for flow alarm.

## Technical information

Adjustability	Adjusting screw
ambient temperature	0°C to +65°C
Media temperature	5°C to +85°C
Storage temperature	5°C to +65°C
Inaccuracy	±5%

## Accessories and options

Flowmeters in other materials or for higher temperature on request.

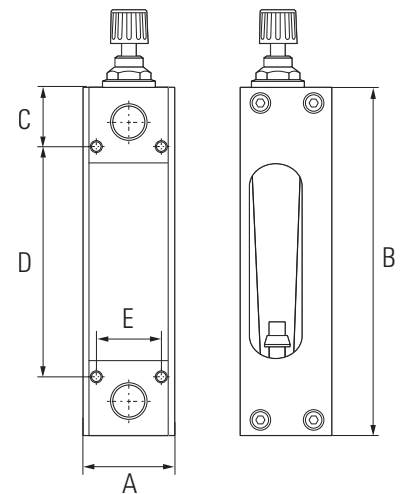

## Installation

The flowmeter is installed in the flow direction horizontally.

## Marking

The pressure sensor is labeled with the manufacturer's name, measuring range and serial number.

## How to order

AT7730-3V		
<b>AT 7730</b>	<b>3</b>	<b>V</b>
Fig. no	Flow area (l/min)	V=Water L=Air

AT 4883	-1	-2,5	-6	-10	-16	-25	-40	-60	-100
Pressure range bar	0-1	0-2,5	0-6	0-10	0-16	0-25	0-40	0-60	0-100
Max. pressure bar	10	16	30	30	50	50	70	70	200

AT7730 Air	-70	-130	-170	-260	-300	-450	-650	-700
Range NI/min	15- 70	30- 130	40- 170	60- 260	75- 300	100- 450	100- 650	150- 700